

C.No. 20036 / 1543 / 2022 .

REF.NO.: 1543 OF P.S., CHOWDAMMAGUTTA THANDA G.P.

T.L.P.NO. 54 / 2023 / H



C.NO:53 / 2023 / HRO /H1
REF NO:20036/1547 Of the E-Panchayat.
DTLP NO. 16 / 2023 /HRO /H1

CAUTION:-
THIS LAYOUT IS LEGALLY VALID ONLY ON ITS RELEASE/ APPROVAL BY THE CONCERNED GRAMPANCHAYAT UNDER SECTION 113(b) TELANGANA PANCHAYAT RAJ ACT 2018 (Act no 5 / 2018) AS COMMENCED WIDE G.O.Ms.No.22 PR & RD DL.18-04-2018 AND UNDER RULE 11 (3) OF G.O.67 PR & RD, DT: 26-02-2002 ON FULLFILMENT OF ALL LAYOUT CONDITIONS. ANY TRANSACTIONS PRIOR TO THE ABOVE IS ILLEGAL.

CHOWDAMMAGUTTA THANDA GRAM PANCHAYAT
EXTRACT OF KISHAN NAGAR VILLAGE MAP
SITE U/R :

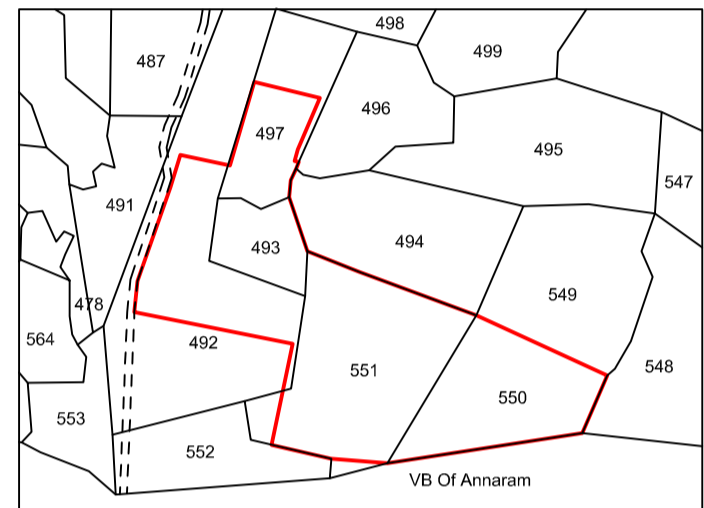

REFERENCE:

- LAYOUT BOUNDARY
- EXISTING ROADS
- PROPOSED ROADS
- MORTGAGE AREA

AREA STATEMENT:

LAYOUT AREA	Ac.34.000 CENTS.	164560.00 SQ.YDS.
SITE RESERVED FOR OPEN SPACE (PARK) (10.00%)	Ac.03.40 CENTS.	1,6456.00 SQ.YDS.
ROADS AREA (30.94%)	Ac.10.52 CENTS.	50916.80 SQ.YDS.
PLOTTED AREA (59.06%)	Ac.20.08 CENTS.	97187.20 SQ.YDS.
MORTGAGE AREA (15.22%) ON PLOTTED AREA (FROM PLOT NO.'S 241 TO 314)	Ac. 3.055 CENTS.	14786.20 SQ.YDS.
NUMBER OF PLOTS	483	

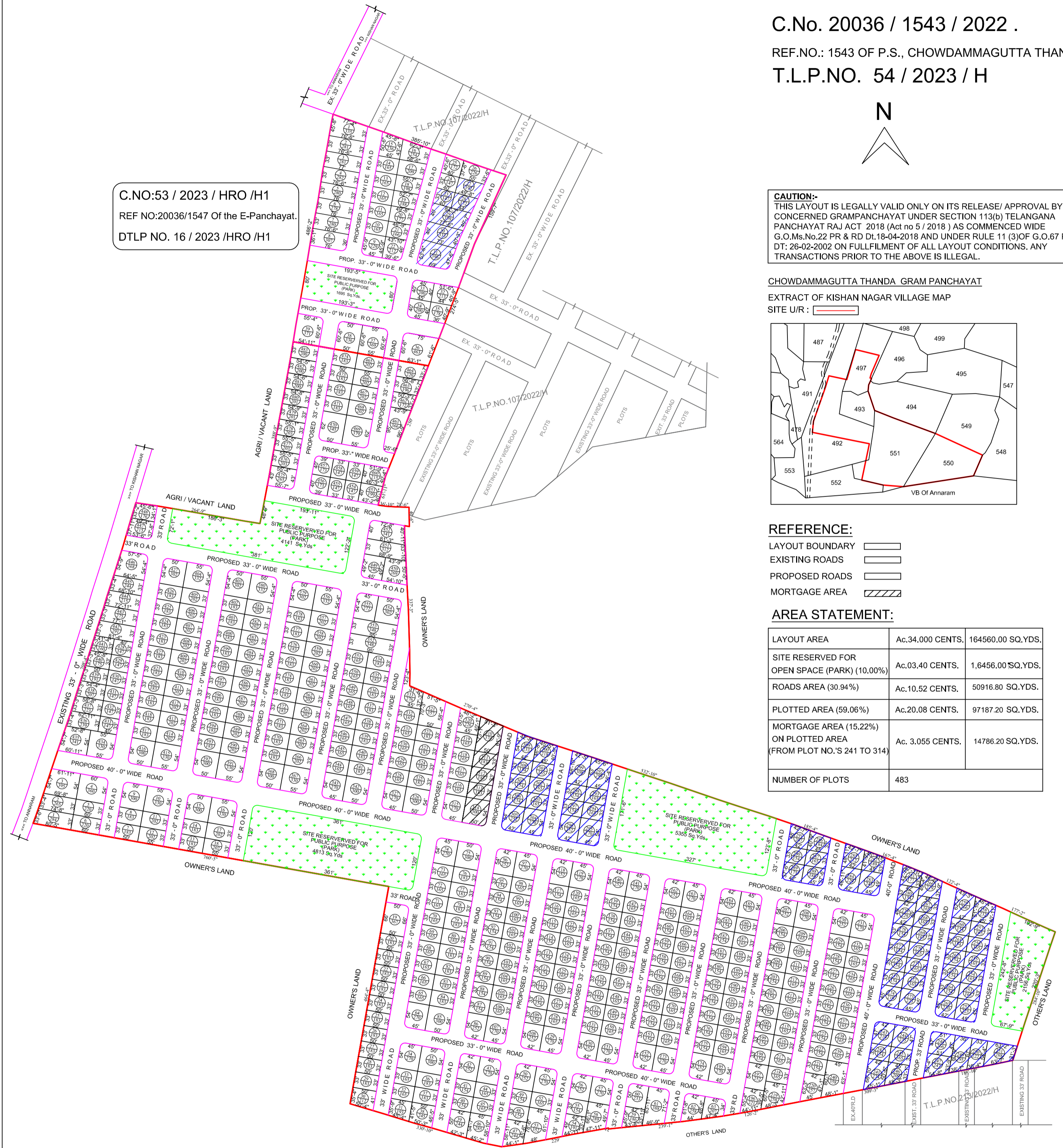

CHOWDAMMAGUTTA THANDA GRAMPANCHAYAT

DRAFT TECHNICAL LAYOUT PATTERN FOR RESIDENTIAL PLOTS IN SY.Nos 492/P, 493,497/P,550, AND 551/P SITUATED AT CHOWDAMMAGUTTA THANDA GRAM PANCHAYAT, KISHAN NAGAR REVENUE VILLAGE, FAROOQNAGAR MANDAL, RANGAREDDY DISTRICT .

SCALE :- 100 FEET TO AN INCH

A.D.M.

T.P.A.

DEPUTY DIRECTOR

JOINT DIRECTOR

B.Arch., M.U.R.P.,F.I.T.P.
DIRECTOR OF TOWN & COUNTRY PLANNING
GOVT. OF TELANGANA, HYDERABAD